

New Mexico v. Abbott
Pueblo Claim Subproceeding II

Exhibit 3a

to

**OHKAY OWINGEH'S REPLY TO THE SANTA CRUZ ACEQUIAS'
& STATE OF NEW MEXICO'S RESPONSES (Docs. #2736 & 2751)
CONCURRING IN TRUCHAS ACEQUIAS' MOTION
FOR PARTIAL SUMMARY JUDGMENT
REGARDING PUEBLO OF SAN JUAN'S ABORIGINAL TITLE TO LANDS
OUTSIDE ITS EXTERIOR GRANT BOUNDARIES (Doc. #2719)**

**Detail from Figure I.6, Overview:
GIS Map of the Santa Cruz Watershed with Site Locations**

from Report of Michael P. Marshall and Henry J. Walt, Ph.D.

**“Eastern Homeland of San Juan Pueblo –
Tewa Land and Water Use in the Santa Cruz and Truchas Watersheds:
An Archaeological and Ethnogeographic Study”
(August 6, 2007)**

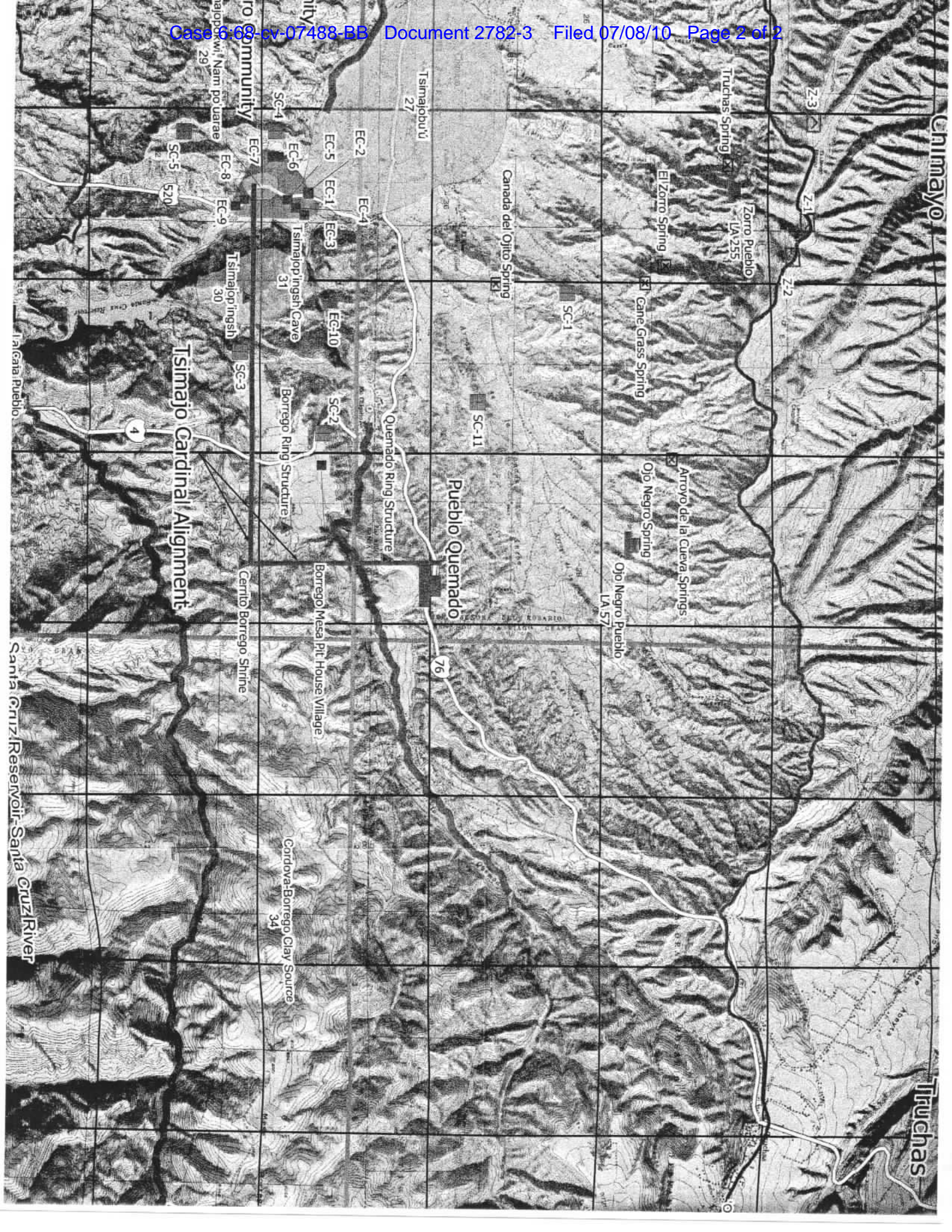

Tsimajo Cardinal Alignment

Pueblo Quemado

Cerro Borrogo Shrine

Cordova-Borrogo Clay Source
34

Borrogo Mesa Pit House Village

Borrogo Ring Structure

Quemado Ring Structure

Tsimajo Ingsh Cave
31

Tsimajo Ingsh
30

SC-5 520

EG-7

EC-8

EC-9

SC-4

EC-6

EC-5

EC-1

EG-3

EG-2

EG-4

EG-5

EG-10

SC-1

SC-11

Tsimajo Ingsh
27

Canada del Ojo Spring

Ojo Negro Pueblo
LA 57

Ojo Negro Spring

Arroyo de la Cueva Springs

Cane Grass Spring

El Zorro Spring

Zorro Pueblo
LA 255

Truchas Spring

Z-3

Z-1

Z-2

Truchas

Chimayo

Santa Cruz Reservoir-Santa Cruz River