

WELL NO.	S.E.O. FILE NO.	PURPOSE
1	RG 7767	COMMERCIAL
2	RG 7767-G-S	"
3	RG NONE	(SANTA FE LODGE)
4	RG 4697	IRRIGATION
5	NONE	SANTA FE MUNICIPAL AIRPORT
6	RG 590	IRRIGATION
7	RG 11826-S	COMMERCIAL
8	RG 11826	"
9	RG 22251-S1	"
10	" " S-2	"
11	" " S-3	"
12	" " S-4	"
13	" " S-5	"
14	" " S-6	"
15	" " S-7	"
16	" " S-8	"
17	RG 22251 & O2125-A	"
18	RG 3824	NEW MEXICO STATE PENITENTIARY
19	RG " X	"
20	" " S	"
21	RG 5530	IRRIGATION
22	RG 01271 INTO 17913	COMMERCIAL
23	RG " S "	"
24	RG 5528	IRRIGATION DESTROYED
25	RG 5529	"
26	RG 19442	IRRIGATION
27	RG 19441	"
28	RG 19440	"
29	RG 19439	"

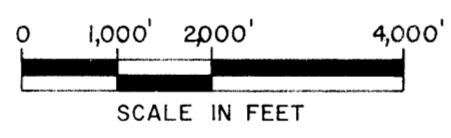

MESITA DE JUANA LOPEZ GRANT NORTH BOUNDARY

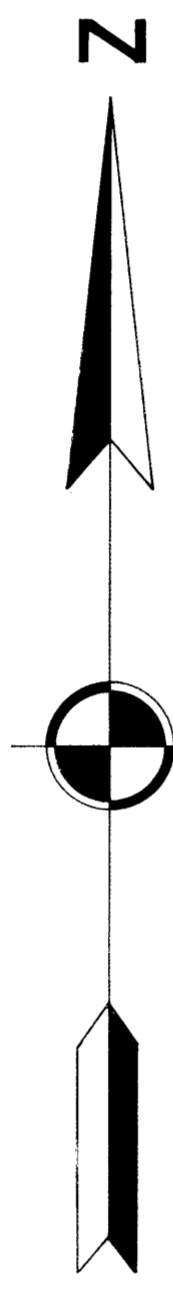
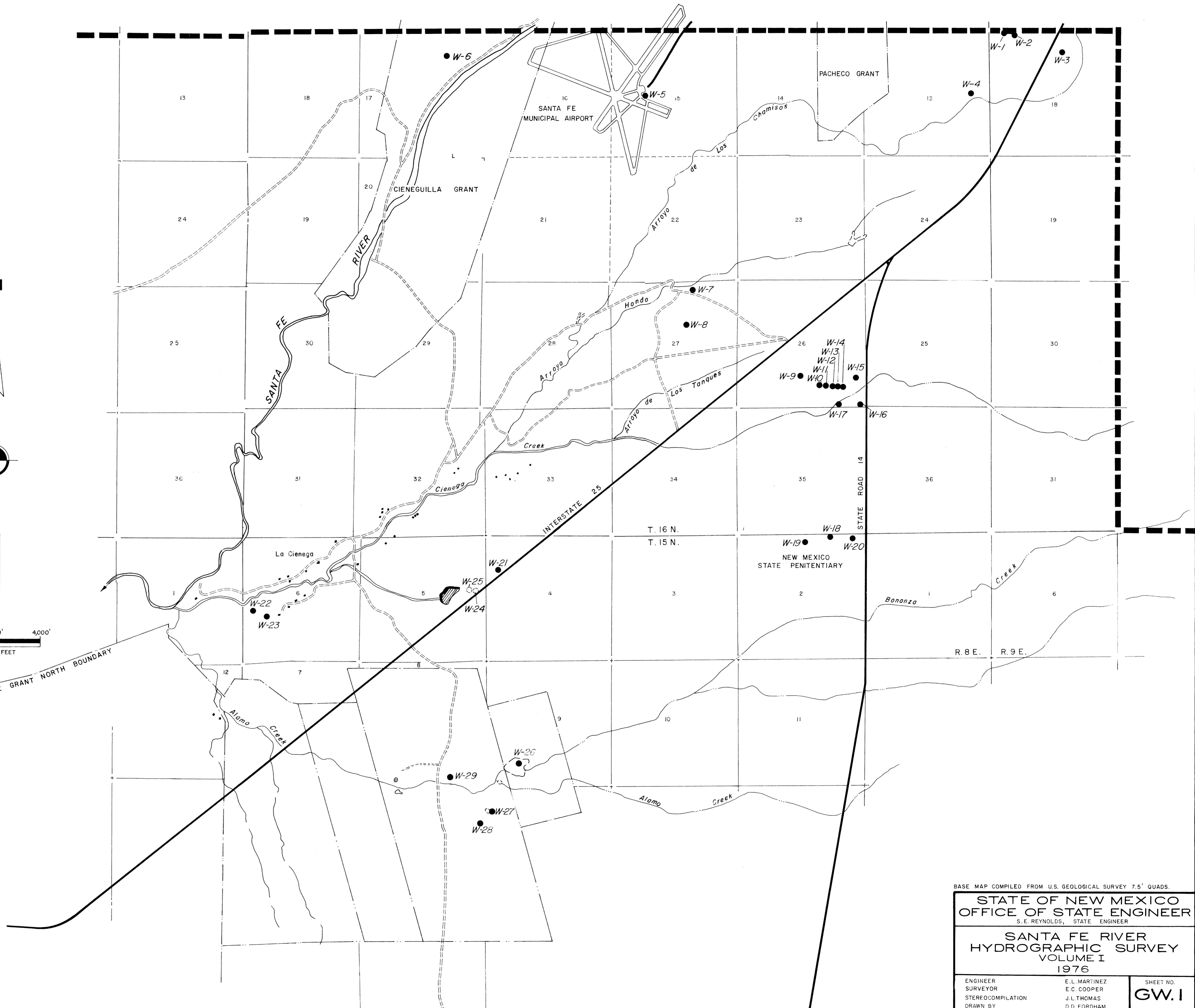

BASE MAP COMPILED FROM U.S. GEOLOGICAL SURVEY 7.5' QUADS.

**STATE OF NEW MEXICO**  
**OFFICE OF STATE ENGINEER**  
S. E. REYNOLDS, STATE ENGINEER

**SANTA FE RIVER**  
**HYDROGRAPHIC SURVEY**  
**VOLUME I**  
**1976**

ENGINEER	E. L. MARTINEZ	SHEET NO.
SURVEYOR	E. C. COOPER	<b>GW. I</b>
STEREOCOMPILATION	J. L. THOMAS	
DRAWN BY	G. D. FORDHAM	