

WELL NO.	S.E.O. FILE NO.	USE
1	RG 19271	SUBDIVISION & RELATED PURPOSES
2	RG 19271-S	"
3	RG 19271-S-2	"
4	RG 1116	CITY OF SANTA FE MUNICIPAL WATER SUPPLY
5	RG 1117	"
6	RG 1113	"
7	RG 1115	"
8	RG 1114	"
9	RG 1118	"
10	RG 18478	IRRIGATION
11	RG 18477	"
12	RG 392	"
13	RG 392-S	"
14	RG 304-S	NONE (PUBLIC SERVICE CO., OSAGE WELL)
15	RG 5841	COMMERCIAL (DAIRY PURPOSES)
16	RG 5840	IRRIGATION
17	RG 1687	INDUSTRIAL (GRAVEL WASHING)
18	RG 1687-S	"
19	RG 11032	COMMERCIAL (NURSERY IRRIGATION & RELATED PURPOSES)
20	RG 1160	IRRIGATION, COMMERCIAL HOUSING & RELATED PURPOSES
21	RG 1139	COMMUNITY DOMESTIC WATER SUPPLY
22	RG 1179	DOMESTIC (PERMITTED 75.11.1. WELL) (COMMERCIAL USE)
23	RG 17476	COMMERCIAL (MOBILE HOME PARK & RELATED PURPOSES)
24	RG 17476-X	"
25	RG 1200	IRRIGATION
26	RG 7767-B	INDUSTRIAL (SAND & GRAVEL WASHING & RELATED PURPOSES)
27	RG 7767-DAS-2	SUBDIVISION & RELATED PURPOSES
28	RG 7767-DAS	"
29	RG 21170	"
30	RG 7767-C	INDUSTRIAL (SAND & GRAVEL WASHING & RELATED PURPOSES)
31	RG 12127	DOMESTIC (OFFICE USE)
32	RG 20379	COUNTRY CLUB & GOLF COURSE (IRRIGATION & DOMESTIC)
33	RG 20379-S	"
34	RG 24042	SUBDIVISION & RELATED PURPOSES
35	RG 15707	IRRIGATION
36	RG 8346	IRRIGATION AND COMMERCIAL (MOBILE HOME PARK)
37	RG 7767-D-S	MOBILE HOME PARK & RELATED PURPOSES
38	RG 361-A INTO RG 12093	COMMERCIAL (TO BE CAPPED)
39	RG 361-A	COMMERCIAL (APARTMENT COMPLEX)
40	RG 361-A-S	"
41	RG 3767	SUBDIVISION & RELATED PURPOSES
42	RG 3767-S	"
43	RG 7767-E	COMMERCIAL (MOBILE HOME PARK, SUBDIVISION, INDUSTRIAL)
44	RG 7767-E-S	"
45	RG 7767-F	COMMERCIAL (MOBILE HOME PARK & RELATED PURPOSES)
46	RG 7767-F-S	"
47	RG 11115	COMMERCIAL (IRRIGATION OF NURSERY)
48	RG 2644	COMMERCIAL (MOBILE HOME PARK & RELATED PURPOSES)
49	RG 2644-X	"
50	RG 2644-X-2	"

WELL NO.	S.E.O. FILE NO.	USE
51	RG 884	COMMERCIAL (DRIVE-IN THEATER & RELATED PURPOSE)
52	RG 53 F	COMMERCIAL (MOBILE HOME PARK & RELATED PURPOSE)
53	RG 53-F-S	"
54	RG 644	COMMERCIAL (TRAILER COURT & RELATED PURPOSES)
55	RG 645	"
56	RG 644 & 645 COMB-S	"
57	NONE	COMMERCIAL (RESTAURANT & RELATED PURPOSES)
58	NONE	COMMERCIAL (MOTEL & RELATED PURPOSES)
59	RG 14070	COMMERCIAL (MOBILE HOME PARK & RELATED PURPOSES)
60	RG 21540	PERMITTED 75.11.1. (MOBILE HOME PARK USE)
61	RG 21541	"
62	RG 1773	COMMERCIAL (DRIVE-IN THEATER & RELATED PURPOSES)
63	RG 2979	NONE
64	RG 591	INDUSTRIAL (SAND & GRAVEL WASHING PURPOSES)
65	RG 29860	MUNICIPAL AIRPORT (SANITARY, DOMESTIC & RELATED PURPOSES)
66	RG 532	COMMERCIAL (MOTEL & RELATED PURPOSES)
67	RG 304	CITY OF SANTA FE MUNICIPAL WATER SUPPLY
68	RG 19584	DOMESTIC, COMMERCIAL, INDUSTRIAL & RELATED PURPOSES
69	NONE	NONE (FORMERLY IRRIGATION)
70	RG 206	INSTITUTIONAL (SCHOOL & RELATED PURPOSES)
71	RG 236-S	"
72	RG 361	IRRIGATION (NURSERY IRRIGATION)
73	RG 542	IRRIGATION
74	RG 240	LIVESTOCK WATER & IRRIGATION
75	RG 288	COMMERCIAL (IRRIGATION OF CEMETERY GROUNDS)
76	RG 605	COMMERCIAL AND IRRIGATION
77	RG 23884-S-2	SUBDIVISION (DOMESTIC, RESIDENTIAL & RELATED PURPOSES)
78	RG 23884-S	"
79	RG 23884	"
80	RG 624	COMMERCIAL (MOTEL & RELATED PURPOSES)
81	RG 20086	SUBDIVISION & RELATED PURPOSES
82	RG 20086-S	"
83	NONE	COMMERCIAL (CAFE, SERVICE STATION & RELATED PURPOSES)
84	NONE	COMMERCIAL (MOTEL, RESTAURANT-BAR & RELATED PURPOSES)
85	RG 19134	COMMERCIAL IRRIGATION OF FRUIT ORCHARD & GARDEN PLOTS WATERING
86	NONE	IRRIGATION
87	NONE	"
88	NONE	COMMERCIAL (MOTEL, RESTAURANT & RELATED PURPOSES)
89	RG 21254	IRRIGATION (GOLF COURSE)
90	RG 30341	OLD ST. MICHAEL'S HIGH SCHOOL WELL

WELL NO.	S.E.O. FILE NO.	USE
91	NONE	COLLEGE OF SANTA FE WELL
92	NONE	OLD NURSERY WELL
93	NONE	OLD CAPITOL WELL
94	NONE	IRRIGATION
95	NONE	OLD NATIONAL GUARD ARMY WELL
96	NONE	OLD STATE PENITENTIARY WELL
97	NONE	INSTITUTE OF AMERICAN INDIAN ARTS WELL
98	NONE	OLD NATIONAL CEMETERY WELL
99	NONE	IRRIGATION
100	NONE	"
101	NONE	"
102	RG 30748	STOCK & DOMESTIC (LOCATION SEC. 4, T. 16 N., R. 8 E. DECLARED COMMERCIAL USE) IRRIGATION & DOMESTIC
103	RG 30318	"
104	RG 30684	COMMERCIAL (MOTEL, RESTAURANT & RELATED PURPOSES)
105	RG 30764	DOMESTIC, STOCK & IRRIGATION
106	RG 27946	IRRIGATION
107	RG 27946-S	IRRIGATION
108	NONE	IRRIGATION-DOMESTIC
109	RG 8224	IRRIGATION-DOMESTIC-STOCK
110	RG 23728	IND-IRRIGATION-DOMESTIC
111	RG 36973	IRRIGATION-COMMERCIAL
112	RG 9884	DOMESTIC-COMMERCIAL & STOCK
113	RG 48630	IRRIGATION-DOMESTIC & SANITATION
114	RG 37834	COMMERCIAL STOCK & DOMESTIC
115	RG 37835	IRRIGATION & STOCK

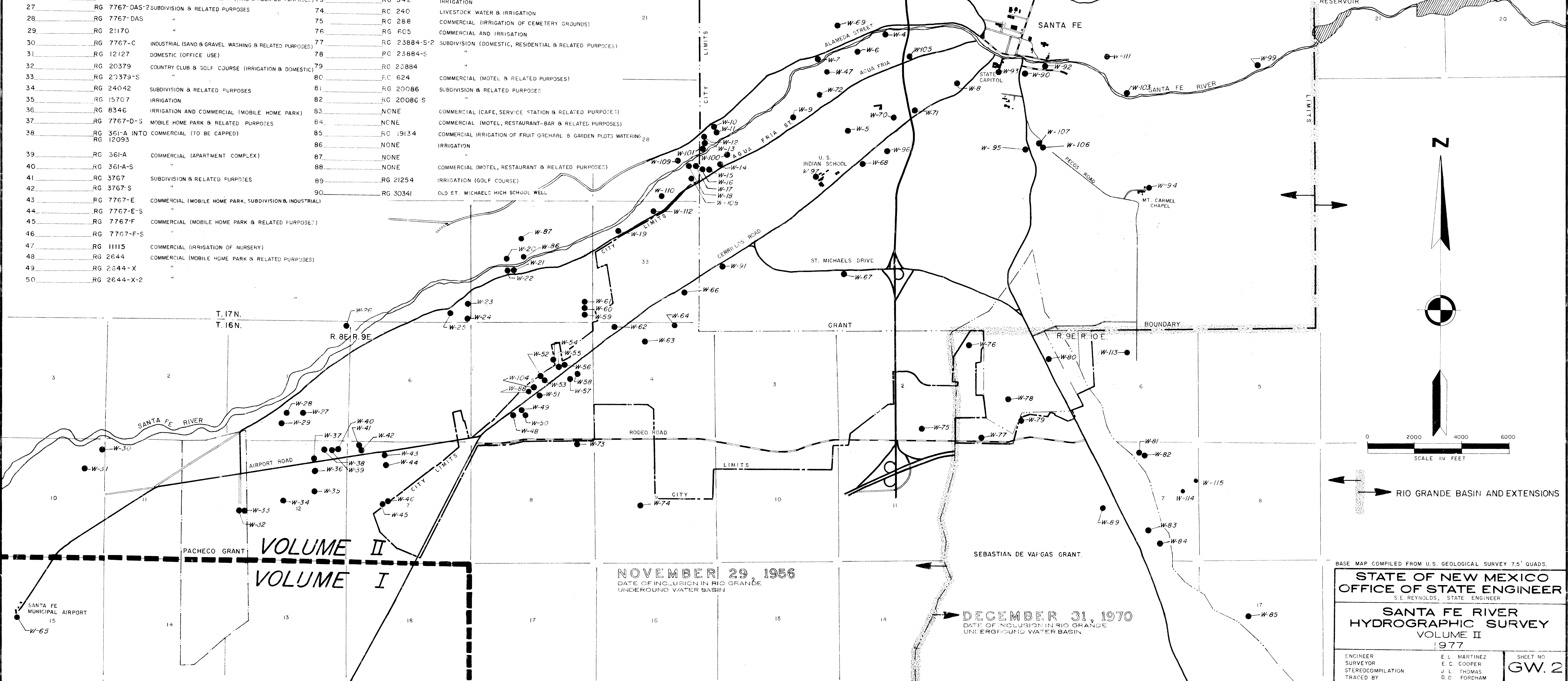

NOVEMBER 29, 1956
DATE OF INCLUSION IN RIO GRANDE UNDERGROUND WATER BASIN

JUNE 8, 1967
DATE OF INCLUSION IN RIO GRANDE UNDERGROUND WATER BASIN

DECEMBER 31, 1970
DATE OF INCLUSION IN RIO GRANDE UNDERGROUND WATER BASIN

NOVEMBER 29, 1956
DATE OF INCLUSION IN RIO GRANDE UNDERGROUND WATER BASIN

DECEMBER 31, 1970
DATE OF INCLUSION IN RIO GRANDE UNDERGROUND WATER BASIN

BASE MAP COMPILED FROM U.S. GEOLOGICAL SURVEY 7.5' QUADS.

STATE OF NEW MEXICO
OFFICE OF STATE ENGINEER
S.E. REYNOLDS, STATE ENGINEER

SANTA FE RIVER
HYDROGRAPHIC SURVEY
VOLUME II
1977

ENGINEER	E. L. MARTINEZ	SHEET NO.
SURVEYOR	E. C. COOPER	GW. 2
STEREOCOMPILATION	J. L. THOMAS	
TRACED BY	D. D. FORDHAM	