

SANTA FE RIVER HYDROGRAPHIC SURVEY

SCALE: 1" = 2000'

BASE MAP COMPILED FROM U.S.G.S. QUADRANGLES

LEGEND

(APPLICABLE TO INDIVIDUAL SURVEY MAPS)

- SURVEY MAP AND NUMBER
- IRRIGATION OWNERSHIP BOUNDARY
- CROP LINES WITHIN IRRIGATION OWNERSHIP BOUNDARY
- SEE INDIVIDUAL MAP SHEETS
- TRACT NUMBER
- RIVER
- DITCH
- INOPERABLE DITCH
- ARROYO
- DIVERSION DAM
- HIGHWAY
- ROAD
- FENCE AND WALL
- NATIONAL FOREST BOUNDARY
- GRANT BOUNDARY
- COUNTY LINE
- WELL (FOR TYPE OF USE SEE INDIVIDUAL SURVEY MAPS)
- SECTION CORNER (projected)
- SECTION CORNER (found)

LAND CLASSIFICATION

IRRIGATED

- (A) ALFALFA
- (C) CORN
- (F2) FALLOW (number indicates number of consecutive years fallow)
- (G) GARDEN
- (H) HAY
- (N) IRRIGATED NATIVE PASTURE
- (IP) IRRIGATED PLANTED & NATIVE PASTURE
- (IPP) IRRIGATED PLANTED PASTURE
- (L) LAWN
- (O) ORCHARD
- (PG) PLOWED GROUND
- (Po) POTATOES
- (W) SMALL GRAINS (wheat, barley, oats)
- (F5) FALLOW OVER FOUR CONSECUTIVE YEARS
- (OL5) FALLOW OVER FOUR CONSECUTIVE YEARS (Prior to June 1, 1965)

NON-IRRIGATED

- (N) IRRIGABLE LAND WHICH HAS NEVER BEEN IRRIGATED
- (S) SWAMP OR BADLY SEEPED LAND
- (T) TREES

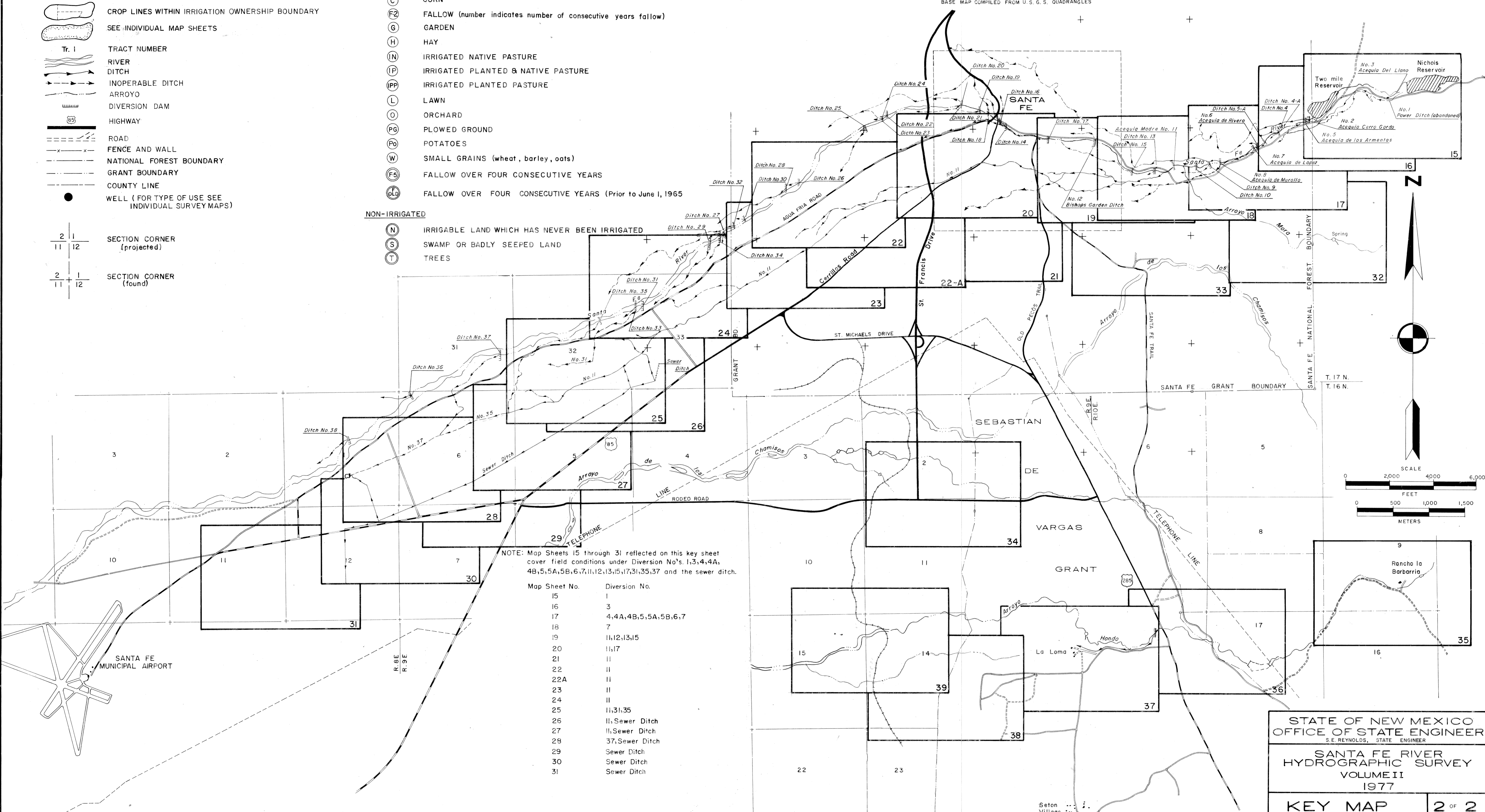

NOTE: Map Sheets 15 through 31 reflected on this key sheet cover field conditions under Diversion No's 1,3,4,4A, 4B,5,5A,5B,6,7,11,12,13,15,17,31,35,37 and the sewer ditch.

Map Sheet No.	Diversion No.
15	1
16	3
17	4,4A,4B,5,5A,5B,6,7
18	7
19	11,12,13,15
20	11,17
21	11
22	11
22A	11
23	11
24	11
25	11,31,35
26	11, Sewer Ditch
27	11, Sewer Ditch
28	37, Sewer Ditch
29	Sewer Ditch
30	Sewer Ditch
31	Sewer Ditch

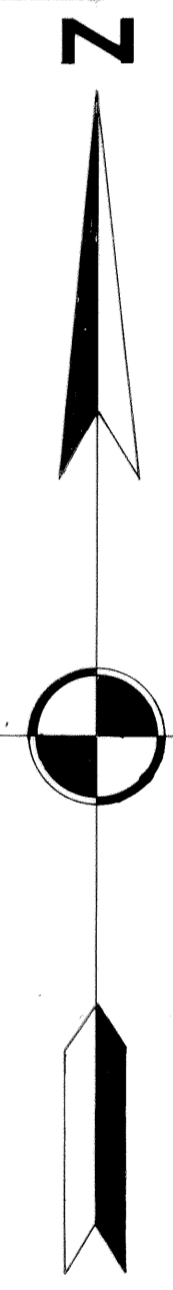
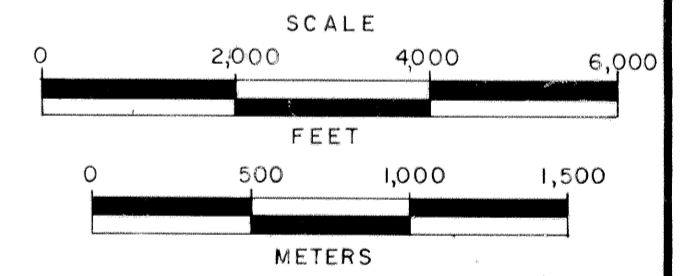

STATE OF NEW MEXICO
OFFICE OF STATE ENGINEER
S.E. REYNOLDS, STATE ENGINEER

SANTA FE RIVER
HYDROGRAPHIC SURVEY
VOLUME II
1977

KEY MAP 2 OF 2