

IN THE UNITED STATES DISTRICT COURT  
FOR THE DISTRICT OF NEW MEXICO

STATE OF NEW MEXICO, *ex rel.*  
State Engineer

Plaintiff,

v.

ROMAN ARAGON, *et al.*,

Defendants.

69cv07941-MV/KK

RIO CHAMA STREAM SYSTEM  
Section 3: Rio Cebolla

Subfile No. CHCB-001-0007

**CONSENT ORDER**

The Court, having considered the agreement between the Plaintiff State of New Mexico and Defendants:

**CHARLIE CHACON  
GERALDA M. CHACON**

concerning the Defendants' right to use the public waters of the Rio Chama Stream System, as set forth below finds:

1. The Court has jurisdiction over the parties and the subject matter of this suit.
2. The State of New Mexico and the above-named Defendants are in agreement concerning certain elements of Defendants' right to divert and use the public waters of the Rio Chama Stream System, Rio Cebolla, Section 3, and by their signatures appearing below, the State and the Defendants have approved and accepted the elements of the Defendants' water rights as set forth in paragraph 4 herein.
3. There is no just reason for delay for the entry of a final judgment as to the elements of the claims of the Defendants adjudicated by this order.

4. The rights of the Defendants to divert and use the public waters from the Rio Chama Stream System, Rio Cebolla, Section 3, are set forth below:

**A. IRRIGATED LANDS (Surface Water Only):**

**Office of the State Engineer File No.** NONE

**Priority:** 1905

**Source of Water:** Surface waters of the Rito de la Piedra, a tributary of the Rito del Tanque, a tributary of the Rio Cebolla, a tributary of the Rio Chama.

**Purpose of Use:** Irrigation

**Point of Diversion:**

**Ditch Name:** SANCHEZ DITCH

**Location X:** 1,582,604 feet **Y:** 2,024,564 feet

New Mexico State Plane Coordinate System, Central Zone, NAD 1983

**Location and Amount of Acreage:**

Township 27N, Range 04E, Section 24, N.M.P.M.

Pt. SE¼

1.0

Total 1.0 acres

As shown on the attached revised Hydrographic Survey Map for Subfile No. CHCB-001-0007.

**Amount of Water:** Reserved for future determination by court order entered July 25, 2000.

**B. Pond (Surface Water Only):**

**Office of the State Engineer File No.** NONE

**Priority:** 1905

**Source of Water:** Surface waters of the Rito de la Piedra, a tributary of the Rito del Tanque, a tributary of the Rio Cebolla, a tributary of the Rio Chama.

**Purpose of Use:** LIVESTOCK WATERING

**Point of Diversion:**

**Ditch Name:** SANCHEZ DITCH

**Location X:** 1,582,604 feet **Y:** 2,024,564 feet

New Mexico State Plane Coordinate System, Central Zone, NAD 1983

**Pond Location and Surface Area:**

Township 27N, Range 04E, Section 24, N.M.P.M.

Pt. SE¼

0.03

Total 0.03 acres

As shown on the attached revised Hydrographic Survey Map for Subfile No. CHCB-001-0007.

**Pond Depth:** 3.0 feet

**Pond Volume:** 0.054 acre-feet

**C. NO RIGHT**

**Office of the State Engineer File No.** NONE

**Priority:** NONE

**Source of Water:** Surface waters of the Rito de la Piedra, a tributary of the Rito del Tanque, a tributary of the Rio Cebolla, a tributary of the Rio Chama.

**Purpose of Use:** NO RIGHT

**Point of Diversion:**

**Ditch Name:** SANCHEZ DITCH

**Location X:** 1,582,604 feet **Y:** 2,024,564 feet

New Mexico State Plane Coordinate System, Central Zone, NAD 1983

**Location and Amount of Acreage:**

Township 27N, Range 04E, Section 24, N.M.P.M.

Pt. SE¼

5.0

Total 5.0 acres

As shown on the attached revised Hydrographic Survey Map for Subfile No. CHCB-001-0007.

**Amount of Water:** NONE

5. Defendants have no surface water rights in the Rio Chama Stream system, Rio Cebolla, Section 3, other than those set forth in this order and those other orders entered by this

Court in this cause.

6. Defendants, their successors, representatives, heirs and assigns, should be enjoined from any use of the surface waters of the Rio Chama Stream System, Rio Cebolla, Section 3, except in strict accordance with the water rights described herein.
7. The water rights described herein, if any, are adjudicated subject to the right of any other water right claimant with standing to object prior to the entry of a final decree.

IT IS THEREFORE ORDERED that the rights of the Defendants to divert and use the waters of the Rio Chama Stream System, Rio Cebolla, Section 3, are as set forth herein. The Defendants, their successors, representatives, heirs and assigns, are enjoined from any diversion or use of the public surface waters of the Rio Chama Stream System, Rio Cebolla, Section 3, except in strict accordance with the water rights described herein or in other orders of the Court.

The Court enters this Consent Order as a final judgment as to the elements of the Defendants' water rights set forth herein, subject to the right of other claimants to file objections to individual adjudication orders, and to the entry of the final decree in this proceeding.

  
\_\_\_\_\_  
MARTHA VÁZQUEZ  
UNITED STATES DISTRICT JUDGE

ACCEPTED:

Charlie Chacon  
Charlie Chacon

ADDRESS: 10745 Prince Dr #8  
Espanola N.M. 87532

DATE: 2/6/17

Geralda M. Chacon  
Geralda M. Chacon

ADDRESS: 1007 A.S. Prince Dr.  
Espanola, NM 87532

DATE: Feb 6, 2017

Ted J. Trujillo  
TED J. TRUJILLO  
Attorney for Charlie and Geralda M. Chacon  
Law Offices of Ted J. Trujillo  
P.O. Box 2185 — P.O. Box 2113  
Española, NM 87532-2185 Santa Cruz, NM 87567  
(505) 351-1632 telephone

Edward G. Newville  
EDWARD G. NEWVILLE  
Special Assistant Attorney General  
Office of the State Engineer  
P.O. Box 25102  
Santa Fe, NM 87504-5102  
(505) 615-6402 telephone

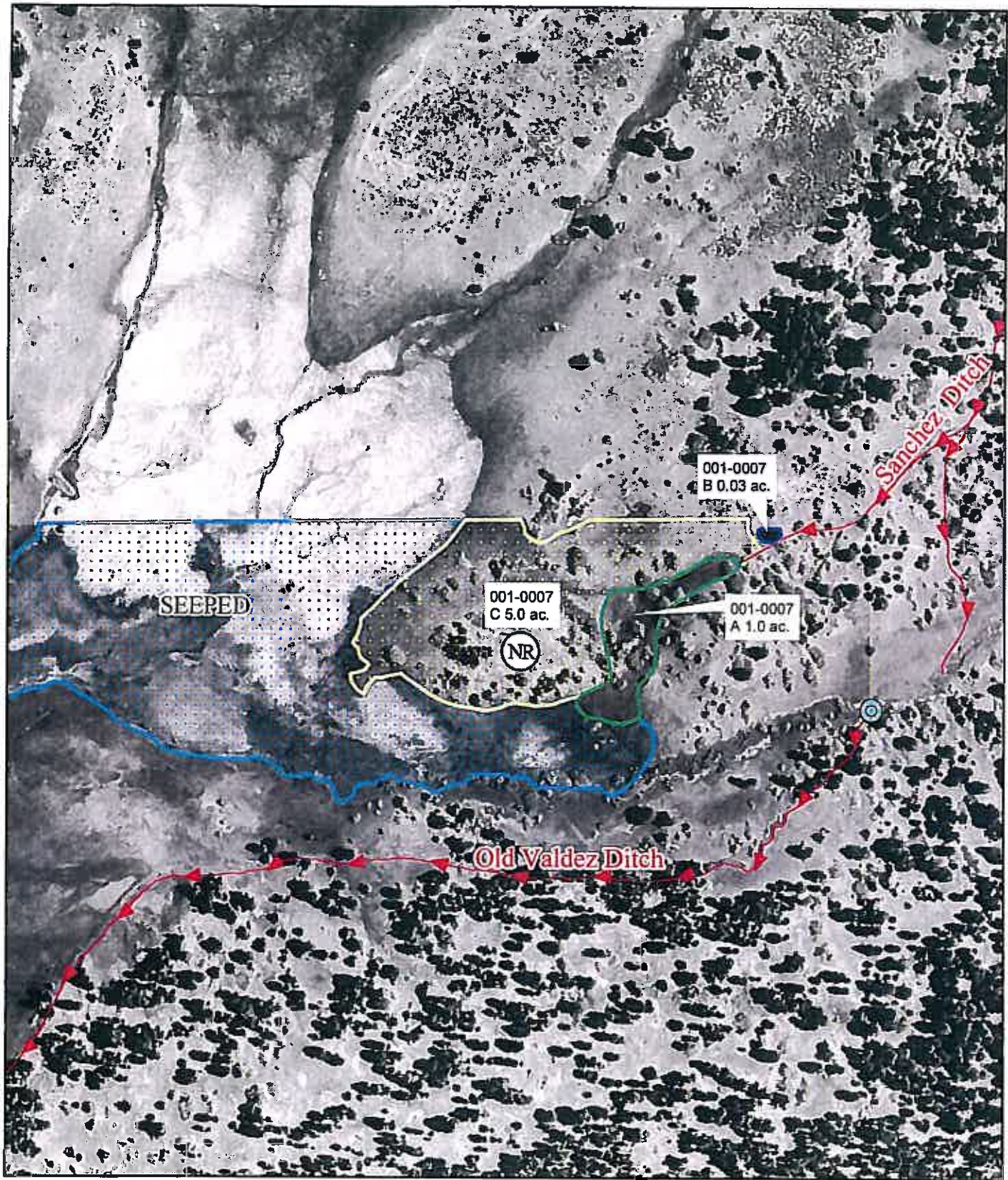

**LEGEND**

- |                          |                    |
|--------------------------|--------------------|
| Irrigated Tract Boundary | Point of Diversion |
| No Right Tract Boundary  | Well               |
| Seeped Area              | Spring             |
| Operable Ditch           | Fallow             |
| Inoperable Ditch         | No Right           |
| Stock Ponds / Reservoir  |                    |

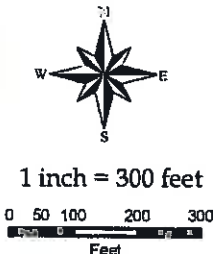

STATE OF NEW MEXICO  
 Office of the State Engineer  
 Tom Blaine, P.E.,  
 State Engineer

Subfile Number  
**CHCB 001-0007**  
 Sanchez Ditch  
 AMENDED  
 January 31, 2017

Rio Chama Hydrographic Survey  
 Rio Cebolla Section

